

RSS TRANSMITTER - OUTDOOR KIT

Rapid Shutdown Activator for TS4-F

The Tigo Rapid Shutdown System (RSS) Transmitter is part of a rapid shutdown solution when paired with Tigo TS4-F (Fire Safety), a PV module rapid shutdown unit. While powered on, the RSS Transmitter sends a signal to the TS4-F units to keep their PV modules connected and supplying energy.

TS4-F units automatically enter rapid shutdown mode when the RSS Transmitter is switched off and resume energy production when power is restored to the RSS Transmitter. This solution complies with NEC 690.12 specifications for 2014, 2017, and 2020 and uses PLC signaling for rapid shutdown.

The RSS Transmitter Outdoor Kit includes an RSS Transmitter, outdoor enclosure, 120/240V_{AC} power supply, and one or two RSS Cores.

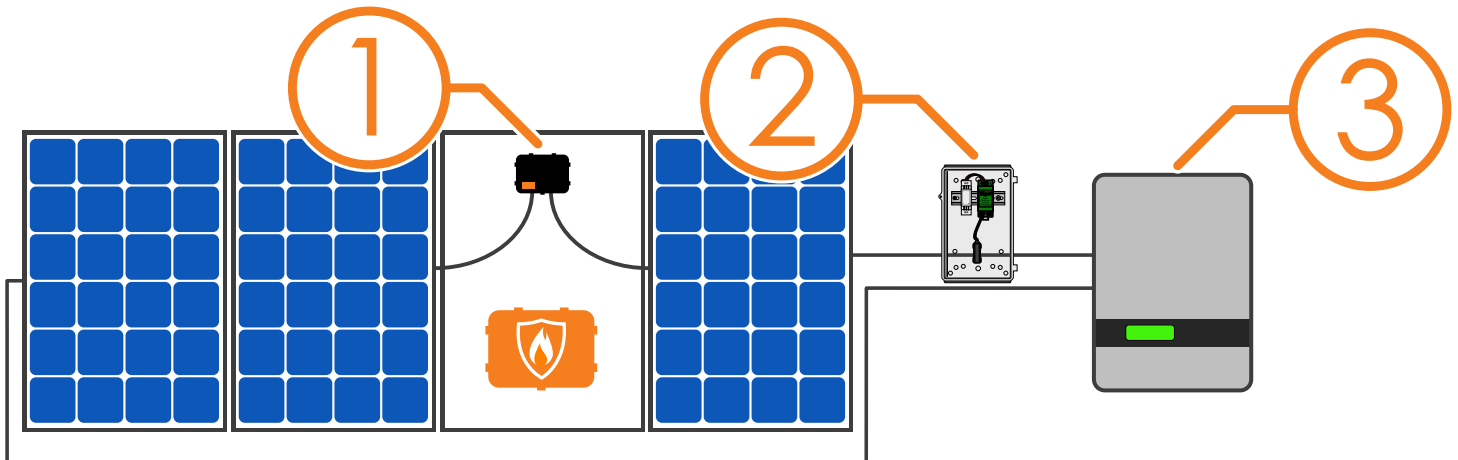

1. Modules equipped with Tigo TS4-F (Fire Safety)
2. Tigo RSS Transmitter with Outdoor Kit
3. Inverter

RSS TRANSMITTER - OUTDOOR KIT

Meets NEC 690.12 requirements
Module-level deactivation with TS4-F
Automatic or manual shutdown
Weatherproof outdoor enclosure
Includes one or two RSS Cores
Includes 120/240V_{AC} power supply

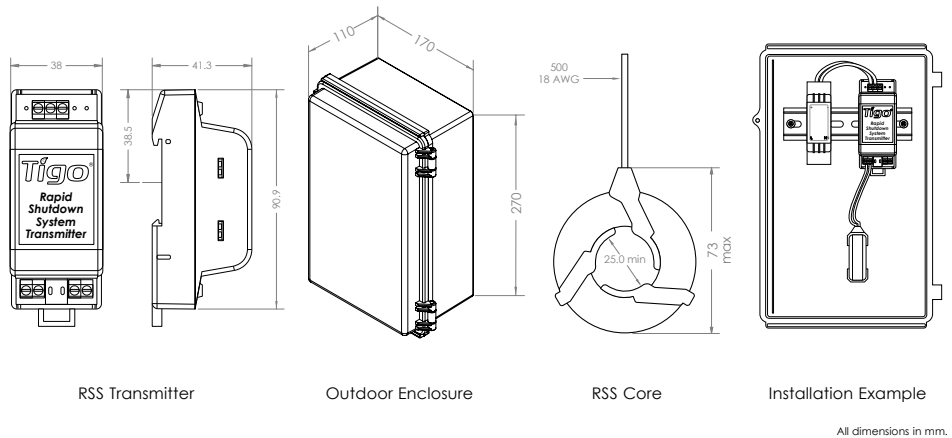

Input

Transmitter Input Voltage: 12V_{DC} (+/- 2%)

Transmitter Input Current: 1A

RSS Core

Max Current (in Outdoor Kit): 100A per RSS Core (Single Core: 100A, Dual Core: 200A)

Max String Voltage: 1500V_{DC}

Max Number of Strings per Core: 10

Max Supported PV Modules per String: 30

Environmental

Operating Temperature Range: -20°C to 50°C (in Outdoor Enclosure)

Enclosure: IP68, NEMA 4

ORDERING OPTIONS

492-00000-10 Single Core RSS DIN Rail Transmitter Kit, 120/240V_{AC} Power Supply, Outdoor Enclosure

492-00000-20 Dual Core RSS DIN Rail Transmitter Kit, 120/240V_{AC} Power Supply, Outdoor Enclosure

For sales info:

sales@tigoenergy.com or 1.408.402.0802

For technical information:

<http://support.tigoenergy.com>

For product info:

Visit www.tigoenergy.com/products

For technical info:

<http://support.tigoenergy.com>

For additional info and product selection assistance, use Tigo's online design tool at www.tigoenergy.com/design





RSS Transmitter with Pure Signal technology

Rapid Shutdown Activator

The Tigo Rapid Shutdown System (RSS) Transmitter is a part of Module Level rapid shutdown solution when paired with Tigo Module Level Power Electronics (MLPE). The RSS Transmitter can link multiple RSS transmitters together, this enables Tigo's Pure Signal Technology, providing one coordinated keep-alive signal to the array.

Features

- PLC Communication
- Scalable from residential to large utility projects
- Patented Pure Signal Technology for multiple transmitters
- Configurable with one or two RSS Cores
- Bi-colored core ensures accurate signal directionality

Benefits

- Meets NEC 690.12 2014, 2017, and 2020 requirements
- Automatic or manual shutdown
- Reduce balance of system cost
- Easy and fast to install
- Compatible with majority of the inverters in the market

Dimensions

Dimensions (W x D x H)	38 x 41.3 x 90.9 mm (1.5 x 1.63 x 3.58in)
------------------------	--

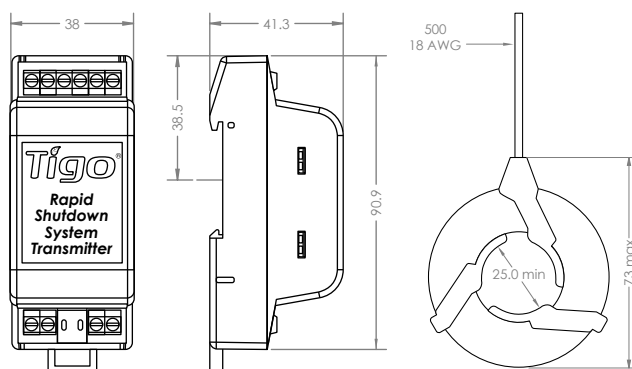

Outdoor Enclosure (optional)	
Dimensions (W x D x H)	170 x 110 x 270 mm (6.69 x 4.33 x 10.63in)

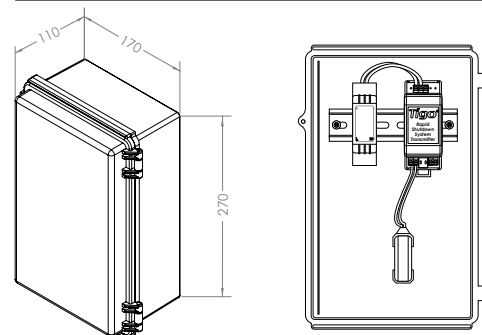

Input

Transmitter Input Voltage	12V _{DC} (+/- 2%)
Transmitter Input Current	1A
Power consumption (Max/Average)	5.5W/0.85W

RSS Core

Max Current	150A per RSS Core (Single Core: 150A, Dual Core: 300A)
Max String Voltage	1500V _{DC}
Max Number of Strings per Core	10
Max Supported PV Modules per String	30

Environmental

Operating Temperature Range	-40°C to +85°C (-40°F to +185°F)
Outdoor Enclosure Temperature Range (optional)	-20°C to +50°C (-4°F to +122°F)
Enclosure Rating (optional)	IP68, NEMA 4

Ordering Options

Item #	Description
490-00000-51	Single Core (150A) RSS Din Rail Transmitter (no PS or enclosure)
490-00000-52	Dual Core (300A) RSS Din Rail Transmitter (no PS or enclosure)
492-00000-51	Single Core RSS Din Rail Transmitter, 120/240VAC PS, Outdoor Enclosure kit
492-00000-52	Dual Core RSS Din Rail Transmitter Kit, 120/240VAC PS, Outdoor Enclosure kit
493-00000-52	Commercial Dual Core RSS Din Rail Transmitter, 480/277VAC PS (no enclosure)

System Components:

1. Modules equipped with Tigo MLPE
2. Tigo RSS Transmitter and RSS Core
3. Inverter

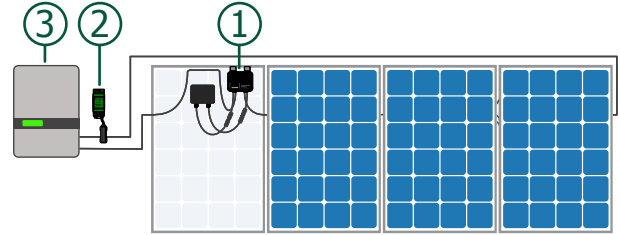

Typical Multi-Inverter Application

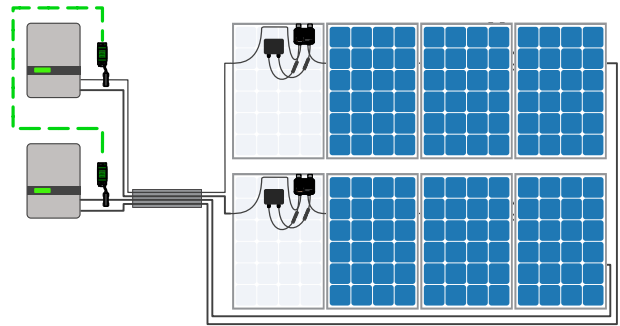

Photovoltaic Rapid Shutdown
System Equipment, QIJJW

Additional resources



Tigo RSS



Community



Support



tigoenergy.com

PN: 002-00096-00 | Rev. 2022.6.28